

**NDOR – Construction and Detour Info – June 28, 2017**

**No map is published - Please use the 511 web area and the [Icons](http://www.511.nebraska.gov) to determine locations. [www.511.nebraska.gov](http://www.511.nebraska.gov)**

The Items listed are ONLY those that are longer than one (1) month in duration. Travelers may encounter items not listed here.

For Roadwork less than one month in duration - Call 511 or 800-906-9069 or by cv:\ahecking the 511 TEXT VERSION page.

*Always check 511 for the most current info.*

**[SUBSCRIBE HERE](#) to Receive Automatic Emails whenever this Document is Updated.**

Highway Number & General Location Info		Additional Info – if available – Restrictions – Type of Work <i>REMEMBER to Check 511 TEXT Page for extra information</i>	Date Entered/ Updated	District	Anticipated Completion
<b>Interstate</b>					
I-80	Between Exit 22: N-71; Gering; Scottsbluff and Exit 38: L-17B; Potter	Road construction, one lane closed, 14' width restriction	5-10-17	5	November 2017
I-80	Between Exit 48: L-17C; Brownson (west of Sidney) and Exit 69: L-17E; Sunol (east of Sidney)	Road construction	5-24-17	5	
I-80	Both directions between Exit 69: L-17E; Sunol and Exit 85: L-25A; Chappell (east of Sidney)	Road maintenance, lane restrictions, 14' width restriction	5-31-17	5	November 2017
I-80	Both directions between Exit 95: N-27; Julesburg; Oshkosh and Exit 102: I-76; N 14 <sup>th</sup> St; Sidney (west of Ogallala exit)	Road construction, lane restrictions, 12' width restriction, head-to-head traffic throughout project	6-7-17	5	November 2017
I-80	Both directions between Exit 158; N-25; Sutherland; Wallace and Exit 177: US-83; North Platte; McCook (west of North Platte)	Road maintenance, 12' width restriction	3-15-17	6	November 2017
I-80	Both directions between Exit 179: L-56G; North Platte and Exit 211: N-47; Gothenburg (east of North Platte)	Road maintenance, lane restrictions, 12' width restriction	4-5-17	6	November 2017
I-80	Westbound between Exit 190: S-56A; Maxwell (east of North Platte) and Exit 164: L-56C; Hershey (west of North Platte)	Utility work	3-29-17	6	October 2017
I-80	Both directions between Downtown Lincoln and Exit 409: US-6; East Lincoln; Waverly (east of Lincoln)	Road maintenance, lane restrictions	6-21-17	1	October 2017
<b>Highways in Nebraska – Numerically</b>					
2	Both directions between S Whitman Rd (east of Hyannis) and 3304 (west of Mullen)	Road maintenance, 12' width restriction, lane restriction	3-29-17	6	September 2017
2	Both directions between US-75 and S 3 <sup>rd</sup> St (near Nebraska City)	Road construction, flaggers, 12' width restriction	3-8-16	1	

Highway Number & General Location Info		Additional Info – if available – Restrictions – Type of Work <i>REMEMBER to Check 511 TEXT Page for extra information</i>	Date Entered/ Updated	District	Anticipated Completion
2	Both directions between US-183 (east of Ansley) and S Main St (east of Mason City)	Road maintenance, lane restrictions with flaggers	4-26-17	6	August 2017
2	Both directions between Valmont Dr and IA 2; Iowa State Line (east of Nebraska City)	Road maintenance, lane restrictions, 12' width restriction	4-26-17	1	October 2017
6	Both directions between East C St (McCook) and Warren St (near Indianola)	Road construction, 12' width restriction	10-5-16	7	December 2017
6	Both directions between Silver St and Pflug Rd (east of Ashland)	Road construction, 12' width restriction, lane restrictions with temporary traffic signals	3-29-17	2	November 2018
6	Eastbound between N 132 <sup>nd</sup> St and I-680 (near Omaha)	Construction work, nighttime, lane restrictions, temporary closures - check message boards	6-21-17	2	November 2017
6	Between Simpson St (west of Cambridge) and Rd 722 (east of Arapahoe)	Road maintenance, lane restrictions with flaggers and a pilot vehicle, 12' width restriction	6-28-17	7	July 2017
7	Both directions between German Valley Rd and W South St (south of Ainsworth)	Road construction, lane restrictions with flaggers and a pilot vehicle, 10' width restriction	5-31-17	8	August 2017
12	Both directions between Turkey Creek Rd and US-183; 11 <sup>th</sup> St (west of Springview)	Road construction, lane restrictions with flaggers and a pilot vehicle	5-3-17	8	July 2017
12	Both directions between 569 <sup>th</sup> Ave and 570 Ave (west of Obert)	Road construction, bridge replacement, road closed - <a href="#">Detour</a>	4-12-17	3	Fall 2017
14	Both directions between Rd 301 and E Division St (south of Clay Center)	Road construction, lane restrictions with flaggers, pilot vehicle and temporary traffic signals, 12' width restriction	5-31-17	4	November 2017
14	Both directions between US-6; Rd Q (north of Clay Center and W 9 Rd (near Aurora)	Road maintenance, 12' width restriction, lane restrictions with flaggers and pilot vehicle	6-14-17	4	August 2017
14	Both directions between Reyner Rd (south of Central City) and 24 <sup>th</sup> St (Central City)	Road maintenance, lane restrictions with flaggers, temporary traffic lights, 12' width restriction	3-8-17	4	August 2017
14	Both directions between 25 <sup>th</sup> St and US-30 (near Central City)	Road maintenance, road closed (follow marked detour)	3-29-17	4	November 2017
14	Between N-52; Belgrade Rd (north of Fullerton) and L-6A (south of Albion)	Road construction, 11' width restriction, traffic maintained with flaggers	5-31-17	3	Fall 2017
15	Between Glenhaven Ct and Ash St (south of David City)	Road construction, 11' width restriction	3-8-17	3	October 2017

Highway Number & General Location Info		Additional Info – if available – Restrictions – Type of Work <i>REMEMBER to Check 511 TEXT Page for extra information</i>	Date Entered/ Updated	District	Anticipated Completion
15	Both directions between Iowa St and G St (near David City)	Road construction, road closed	6-14-17	1	November 2017
15	Both directions between County Rd V (north of Schuyler) and 829 <sup>th</sup> Rd (south of Pilger)	Bridge work, road closed - <a href="#">Detour</a>	4-12-17	3	Fall 2017
L-17F	Between I-80 and US-30	Road construction, lane closures with temporary traffic signals	5-24-17	5	November 2017
20	Between S-23A; Whitney Spur Rd (east of Crawford and US-385 (west of Crawford)	Road construction	5-31-17	5	
20	Both directions between Oak St and Spruce St (near Chadron)	Road construction	11-30-16	5	
20	Both directions between Oakdale Rd and N-12 (west of Jackson)	Road construction, one lane bridge with temporary traffic signals, 15' width restriction	5-24-17	3	Summer 2017
20	Both directions between Norway Ave and 143 <sup>rd</sup> St (west of Jackson)	Road construction, one lane bridge with temporary traffic signals, 15' width restriction	5-24-17	3	Summer 2017
22	Both directions between US-281 (west of Wolbach) and North Star Rd (east of Wolbach)	Road construction, lane restrictions with flaggers and a pilot vehicle, 11' width restriction	3-29-17	4	June 2017
22	Both directions between Merrick Rd (east of Wolbach) and N-14; Johnson St (Fullerton)	Road construction, lane restrictions with flaggers and a pilot vehicle, 11' width restriction	3-29-17	4	June 2017
23	Both directions between Rd 409 (near Farnam) and Rd 420 (east of Eustis)	Road maintenance, lane restrictions with flaggers and a pilot vehicle, 12' width restriction	5-24-17	7	
30	Both directions between 23 <sup>rd</sup> Ave and Greenwood Rd (near Sidney)	Road construction, lane restrictions, 12' width restriction	4-5-17	5	September 2017
30	Both directions between W Paint Horse Rd (east of North Platte) and S Gun Club Rd (east of Maxwell)	Road construction, lane restrictions with temporary traffic signals and flaggers, 11' width restriction	6-7-17	6	November 2017
30	Both directions between E Ave and 13 <sup>th</sup> Ave (near Central City)	Road maintenance, lane restrictions with flaggers, 12' width restriction	3-29-17	4	November 2017
30	Both directions between County Rd 15 (west of Rogers) and County Rd 4 (east of Rogers)	Road construction, traffic maintained	3-8-17	3	Fall 2017
30	Both directions between US-75; NE 91; Washington St and S 12 <sup>th</sup> St (Blair)	Road construction, 12' width restriction, 65' length limit	5-31-17	2	September 2017

Highway Number & General Location Info		Additional Info – if available – Restrictions – Type of Work <i>REMEMBER to Check 511 TEXT Page for extra information</i>	Date Entered/ Updated	District	Anticipated Completion
30	Both directions between Lehman Rd and S Jackson Rd (west of Maxwell)	Road construction, one lane bridge with traffic signal being used, 11' wide restriction	5-31-17	6	
34	Both directions between Rd D (east of Hampton) and Rd G (west of York)	Road maintenance, lane restrictions with flaggers and a pilot vehicle	6-28-17	4	
34	Between Platte River Dr and US-75 (north of Plattsmouth)	Road construction, lane restrictions	11-23-16	2	
34	Both directions between Bay Rd and US-75 (north of Plattsmouth)	Road construction, lane restrictions, 12' width limit, head-to-head traffic	3-8-17	2	
35	Both directions between 855 <sup>th</sup> Rd and N-98 (west of Wayne)	Road construction, one lane bridge with temporary traffic signals, 11' width restriction	6-7-17	3	May 2017
35	Between 855 <sup>th</sup> Rd and 574 <sup>th</sup> Ave (west of Wayne)	Road construction, 12' width restriction, traffic maintained	6-7-17	3	June 2017
36	Both directions between US-275 and Tyro Rd (west of Bennington)	Road construction, lane restrictions with flaggers and a pilot vehicle, temporary traffic signals, 12' width restriction	4-5-17	2	November 2017
51	Both directions between Broadway and IA 175; Decatur Bridge; Iowa State Line (near Decatur)	Road construction, one lane bridge with temporary traffic signals, 9' width restriction	4-5-17	3	Fall 2017
L-55W	Both directions between US-77 and N-2 (Lincoln)	Road construction, 11' width restriction, 80' length restriction	3-29-17	1	November 2017
L-55W	Northbound between Old Cheney Rd and N-2 (Lincoln)	Road construction, road closed northbound	5-3-17	1	September 2017
61	Both directions between 741 Road (north of Imperial) and N-23 (south of Ogallala)	Road maintenance, lane restrictions with flaggers and pilot vehicle, 12' width restriction	6-7-17	7	July 2017
L-62A	Between County Rd 75 and the end of L-62A	Road construction, 12' width restriction, lane restrictions with flaggers and a pilot vehicle	5-17-17	5	
64	Both directions between US-275 and Center St (Omaha)	Road construction, lane restrictions, 11' width restriction	6-28-17	2	December 2017
64	Both directions between N 99 <sup>th</sup> St and N 85 <sup>th</sup> St (near Omaha)	Road maintenance, lane restrictions, 10' width restriction	6-28-17	2	August 2017
67	Both directions between N-128; N Rd and 3 <sup>rd</sup> St (near Lorton)	Road construction, road closed, follow marked detour, 11' width restriction on detour	6-7-17	1	November 2017

Highway Number & General Location Info		Additional Info – if available – Restrictions – Type of Work <i>REMEMBER to Check 511 TEXT Page for extra information</i>	Date Entered/ Updated	District	Anticipated Completion
70	Both directions between N 13 <sup>th</sup> St and Springdale Rd (near Ord)	Road maintenance, 10' width restriction, lane restrictions with temporary traffic signals	6-7-17	4	October 2018
71	Between County Road 52 (north of Kimball) and S-4A (north of Harrisburg)	Road construction, lane restrictions, 12' width restriction	6-7-17	5	
75	Both directions between K; K Rd and N-2 (near Nebraska City)	Road construction with flaggers, 12' width restriction, 80' vehicle length limit	5-4-16	1	October 2017
75	Both directions between US-34 and Fairview Rd (south of Bellevue)	Road construction	6-22-16	2	
75	Both directions between US-34 (south of Bellevue) and CF F120 Capehart Rd (Bellevue)	Road work, 12' width restriction, head-to-head traffic	3-8-17	2	
75	Both directions between US-30; N-91; Washington St and N 28 <sup>th</sup> Ave (north of Blair)	Road construction, 12' width restriction, 65' length limit	5-17-17	2	September 2017
75	Between County Rd P35 and US-30; Washington St (near Blair)	Road work, 12' width restriction, 65' length limit	5-31-17	2	
83	Both directions between Sturtz Rd and Johnston Rd (north of North Platte)	Road maintenance, lane restriction with flaggers, 12' width restriction	4-26-17	6	July 2017
83	Between Brownlee Rd and S-16B (south of Valentine)	Road maintenance, lane restrictions with flaggers and a pilot vehicle	6-14-17	8	September 2017
84	Both directions between N-13 (east of Center) and 545 Ave (near Bloomfield)	Road construction, road closed – <a href="#">Detour</a>	3-29-17	3	July 2017
85	Both directions between Harrison St and Lakeview St (near Ralston)	Road construction, lane restrictions	5-24-17	2	December 2017
85	Both directions between Harrison St and Main St (Ralston)	Road construction, 12' width restriction	5-24-17	2	December 2017
87	Between County Rd 59 (north of Alliance) and 436 <sup>th</sup> Trl (south of Hay Springs)	Road construction, flaggers and a pilot vehicle	5-10-17	5	
89	Westbound between D Rd (east of Stamford) and Rd 436 (west of Stamford)	Road maintenance, 10' width restriction with flaggers and temporary traffic lights	9-14-16	7	
91	Both directions between County Rd 6-22 and County Rd L-5B (west of Taylor)	Road maintenance, lane restrictions with flaggers and a pilot vehicle, 11' width restriction	4-26-17	6	July 2017
91	Both directions between County Rd 19 (west of Snyder) and Cedar St (Snyder)	Road construction, lane restrictions with flaggers and temporary traffic signals, 12' width restriction	4-5-17	2	November 2017

Highway Number & General Location Info		Additional Info – if available – Restrictions – Type of Work <i>REMEMBER to Check 511 TEXT Page for extra information</i>	Date Entered/ Updated	District	Anticipated Completion
92	Westbound between US-275 and Shamrock Blvd (east of Mead)	Road construction, temporary traffic signals	6-14-17	2	Fall 2017
92	Between County Rd 7 and CR 96; S 264 <sup>th</sup> St (east of Mead)	Road construction, 12' width restriction	6-28-17	2	November 2017
94	Both directions between US-77 and BIA 2 (east of Walthill)	Road construction, road closed – <a href="#">Detour</a>	6-7-17	3	July 2017
103	Both directions between Van Dorn Rd (near Pleasant Dale) and US-6 (north of Pleasant Dale)	Road construction, road closed – use detour	3-8-17	1	October 2017
112	Both directions between N-8; SW 18 Rd and L-34H; West Pwf Rd	Road construction, road closed - follow marked detour	6-21-17	1	July 2017
133	Both directions between County Rd 36 and Placid Pond Ln (south of Blair)	Road construction, 12' wide restriction	5-31-17	2	December 2017
136	Both directions between Maple St and Oak St (near Fairbury)	Road construction, road closed (follow marked detour)	3-29-17	1	November 2017
138	Both directions between Colorado State Line and Rd 197 (west of Big Springs)	Road construction	7-20-16	5	
183	Both directions between W 100 Ln; Kansas State Line and 704 Rd (south of Alma)	road construction, lane restrictions with temporary traffic signals, 12' width restriction	6-14-17	7	July 2017
183	Between Rd A (south of Alma) and US-136; 7 <sup>th</sup> St (Alma)	Road maintenance, temporary traffic signals, 10' width restriction	6-14-17	7	October 2017
183	Both directions between 745 Rd and 11 <sup>th</sup> Rd (south of Elm Creek)	Road maintenance, lane restrictions with flaggers and a pilot vehicle, 12' width restriction	6-21-17	4	August 2017
275	Both directions between S 49 <sup>th</sup> St and S 25 <sup>th</sup> St (near Norfolk)	Road construction	2-1-17	3	June 2017
275	Between 15 <sup>th</sup> Rd and N Mill St (west of West Point)	Road construction, lane restrictions, one lane bridge with flaggers, 9' width restriction	6-7-17	3	June 2017
275	Both directions between S 13 <sup>th</sup> St and Iowa State Line	Road construction, 12' width restriction, bridge closed to pedestrians	4-5-17	2	October 2017
281	Both directions between N-22 (north of St. Paul) and N-22 (south of Greeley)	Road maintenance	11-30-16	4	
281	Both directions between Oil Rd (south of Spencer) and N-12 (Spencer)	Road maintenance, lane restrictions with flaggers and a pilot vehicle, temporary traffic signals	5-17-17	8	September 2017
281	Both directions between NE-56 and W O'Neill Ave (Greeley Center)	Road construction, lane restrictions, 10' width limit, temporary traffic lights	5-31-17	4	July 2017

Highway Number & General Location Info		Additional Info – if available – Restrictions – Type of Work <i>REMEMBER to Check 511 TEXT Page for extra information</i>	Date Entered/ Updated	District	Anticipated Completion
281	Both directions between West Stolley Park Road and 47; West Prairie Road (north of Grand Island)	Road construction, lane restrictions, 12' width restriction	6-7-17	4	September 2017
385	Between N County Rd and Otoe Rd (south of Alliance)	Road construction	7-20-16	5	

## District Phone Numbers

District 1 .....	(402) 471-0850
District 2 .....	(402) 595-2534
District 3 .....	(402) 370-3470
District 4 .....	(308) 385-6265
District 5 .....	(308) 436-6587
District 6 .....	(308) 535-8031
District 7 .....	(308) 345-8490
District 8 .....	(402) 387-2471



# DETOUR

## WALTHILL EAST

THURSTON COUNTY

DISTRICT 3  
STP-94-7(105)  
C.N. 31511

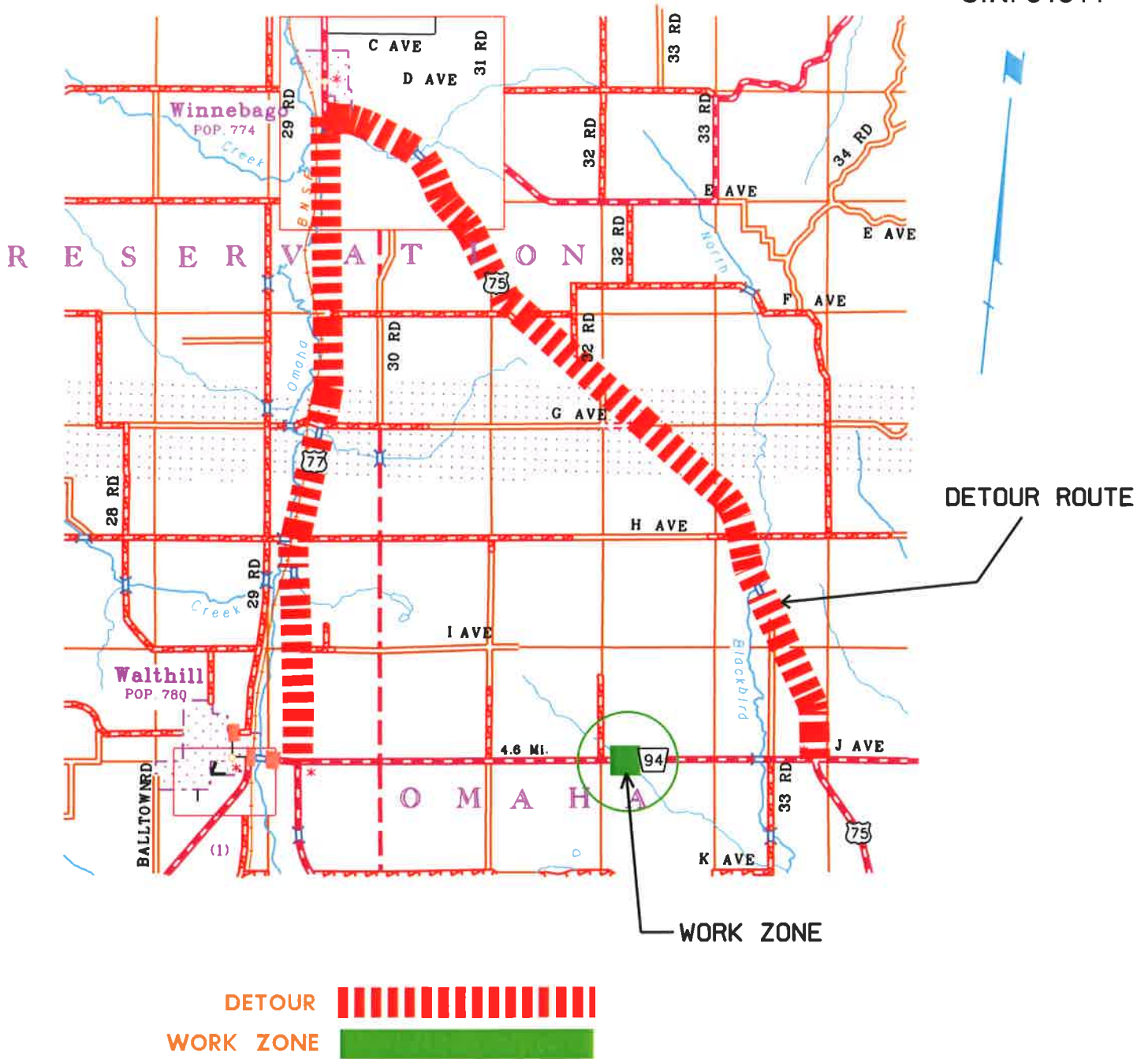

# DETOUR

N-91 North  
15-3(115)  
C.N. 32132  
Stanton/Colfax Counties

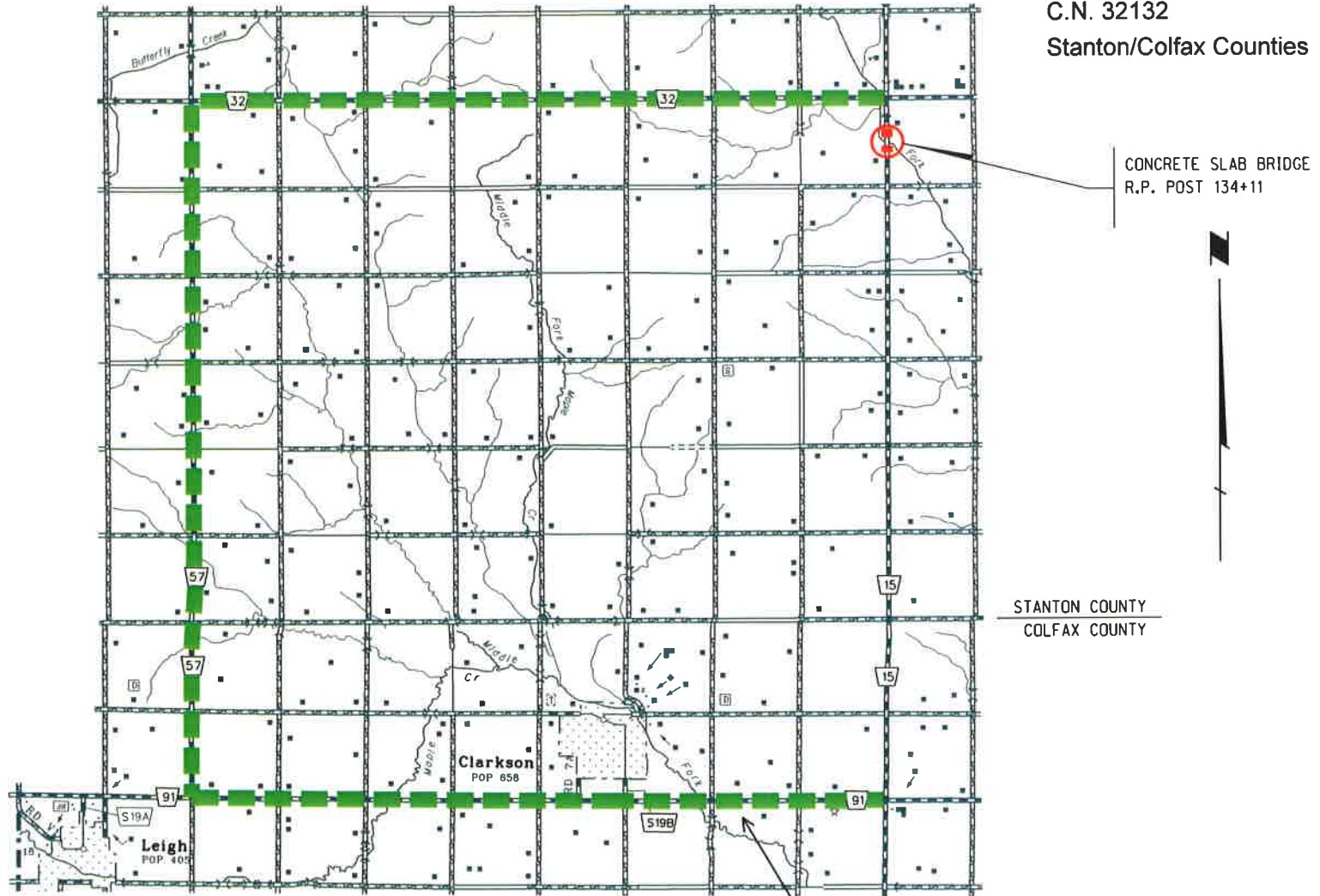

STANTON COUNTY  
COLFAX COUNTY

DETOUR LOCATION MAP

DETOUR



BRIDGE CONSTRUCTION

DETOUR ROUTE (USE ONLY FOR THE REPLACEMENT OF THE BRIDGE ON N-15 AT REFERENCE POST 134+11)



WYNOT EAST & WEST  
CEDAR COUNTY

DISTRICT 3

12-6(117)

C.N. 32131

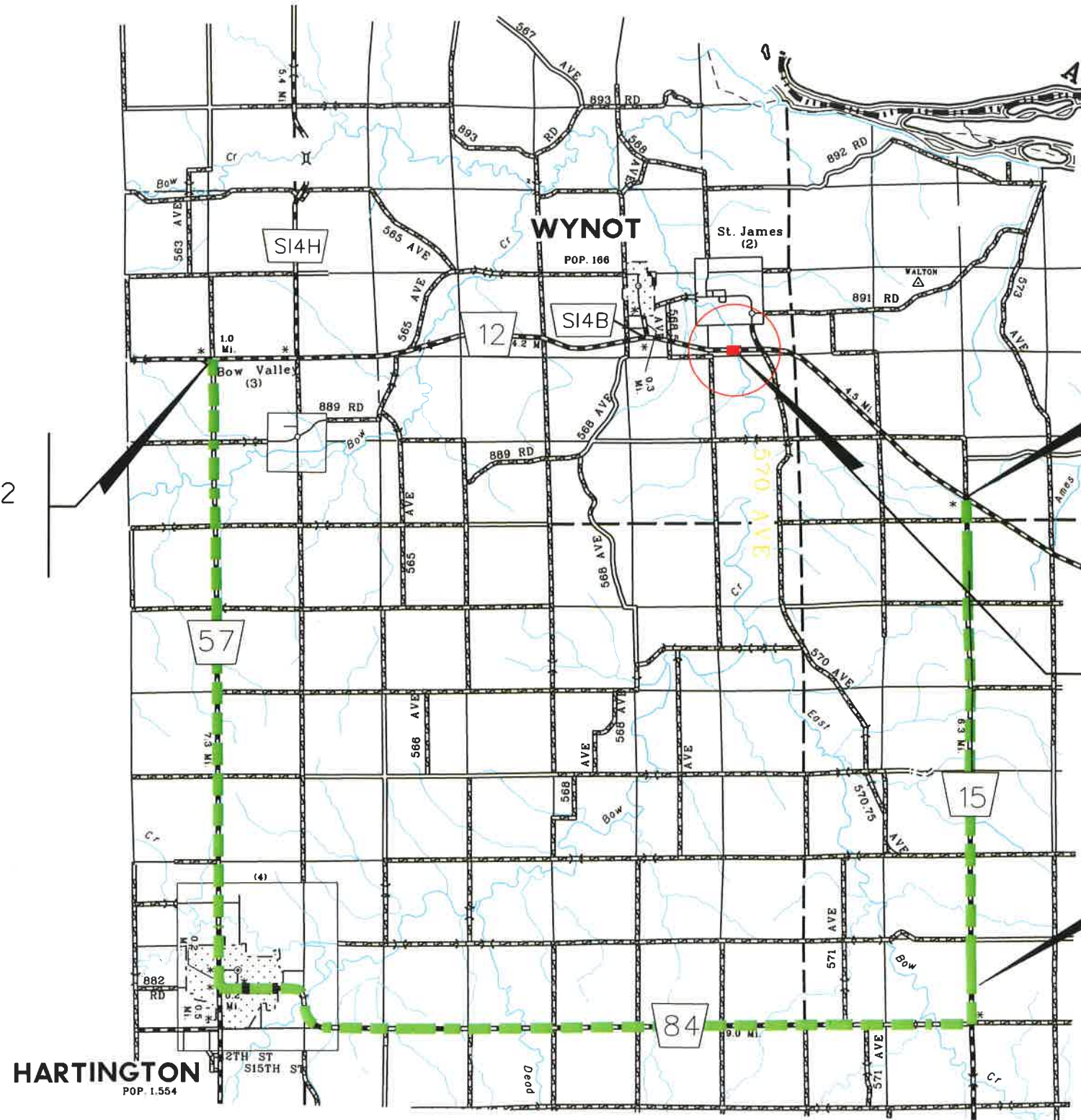

BEGIN DETOUR N-12  
R.P. 201+13

END DETOUR N-12  
R.P. 210+79

**BOW CREEK BRIDGE REPLACEMENT**  
R.P. 207+44

PROJECT DETOUR ROUTE

LEGEND

- PROJECT CONSTRUCTION
- DETOUR ROUTE



DISTRICT 3  
DETOUR

CENTER - BLOOMFIELD  
STP-84-5(109)  
C.N. 31892

