

PROJECT FACT SHEET

Leota St – Philip St (SB), North Platte

NH-83-2(132); C.N. 61363

Philip St – 1st St (SB), North Platte

NH-83-2(130); C.N. 61361

LOCATION

Identified as *Leota St – Philip St (SB), North Platte* and *Philip St – 1st St (SB), North Platte*, the proposed projects would reconstruct approximately 1.08 miles of southbound U.S. Highway 83 (US-83) and 0.05 miles of W Francis Street in North Platte. *Leota St – Philip St (SB), North Platte* would begin at the north approach slab of the South Platte River Bridge, at about mile marker (MM) 82.04, and extend north to MM 82.53, just north of the intersection of US-83 and Philip Avenue. The project would extend west on W Francis Street from the intersection with US-83, to just east of the intersection of W Francis Street and Lucille Street. *Philip St – 1st St (SB), North Platte* would begin north of the US-83 and Philip Avenue intersection and continue north to about MM 83.12, just north of the intersection of US-83 and 1st Street. Construction may begin and/or end approximately 200 feet ahead of or beyond the actual project limits to accommodate transitioning the pavement for both projects.

PURPOSE AND NEED

The purpose of these projects is to preserve the transportation asset, improve the reliability of the transportation system, and ensure the mobility of the traveling public. The need for the proposed projects is based on the current condition of the existing roadway.

SCOPE OF WORK

Proposed improvements would consist of removing the existing pavement and replacing it with doweled concrete pavement with integral curb. Additional work would include removing and replacing the existing storm sewer system, replacing curb inlets, and constructing new pedestrian facilities and sidewalks. Roadway lighting and signals would be updated. Existing surfaced driveways and intersections would be reconstructed.

TRAFFIC VOLUMES

US-83 MM 82.04 - 82.53		
Year	2023	2043
Vehicles Per Day	10,350	10,480
% Trucks	5%	5%

US-83 MM 82.53 - 83.12		
Year	2023	2043
Vehicles Per Day	10,105	10,105
% Trucks	4%	4%

CONSTRUCTION SCHEDULE

Construction would occur concurrently for the proposed projects and could begin as early as spring of 2023 and be completed by the winter of 2024.

ACCOMMODATION OF TRAFFIC

No detour of US-83 is anticipated for construction activities on either of the projects. The projects would be constructed under traffic with lane closures controlled by appropriate traffic control devices and practices; however, the proposed projects would require alternating temporary closures of side streets along US-83. These streets include: Riverside St., W Francis St., William Ave., Reid Ave., G St., F St., E St., D St., C St., and A St. Sidewalk closures would be necessary during construction; designated detours would be provided for pedestrian traffic.

RIGHT-OF-WAY

The projects would require the acquisition of additional property rights, which could include new right-of-way (ROW), control of access (CA), permanent easements (PE), and/or temporary easements (TE). If your property is impacted by this project, you will be contacted by a representative once the design footprint has been established. Access to adjacent

- Leota St - Philip St (SB), North Platte
- Philip St - 1st St (SB), North Platte

properties would be maintained during construction but may be limited at times due to phasing requirements; access to businesses and emergency service facilities may be affected during construction.

POTENTIAL IMPACTS

Due to the urban nature of the projects, no wetland or other water resource impacts are anticipated. No historic properties have been identified along these projects.

ESTIMATED COST

The total cost of the proposed projects is approximately \$9.5 million and would be derived from local, federal, and state funding sources.

i For more information, contact:

Sarah Fisher, NDOT Public Involvement
 sarah.fisher@nebraska.gov | 402-479-3832

Gary Thayer, District 6 Engineer
 gary.thayer@nebraska.gov | 308-535-8031

ndot.info/61361

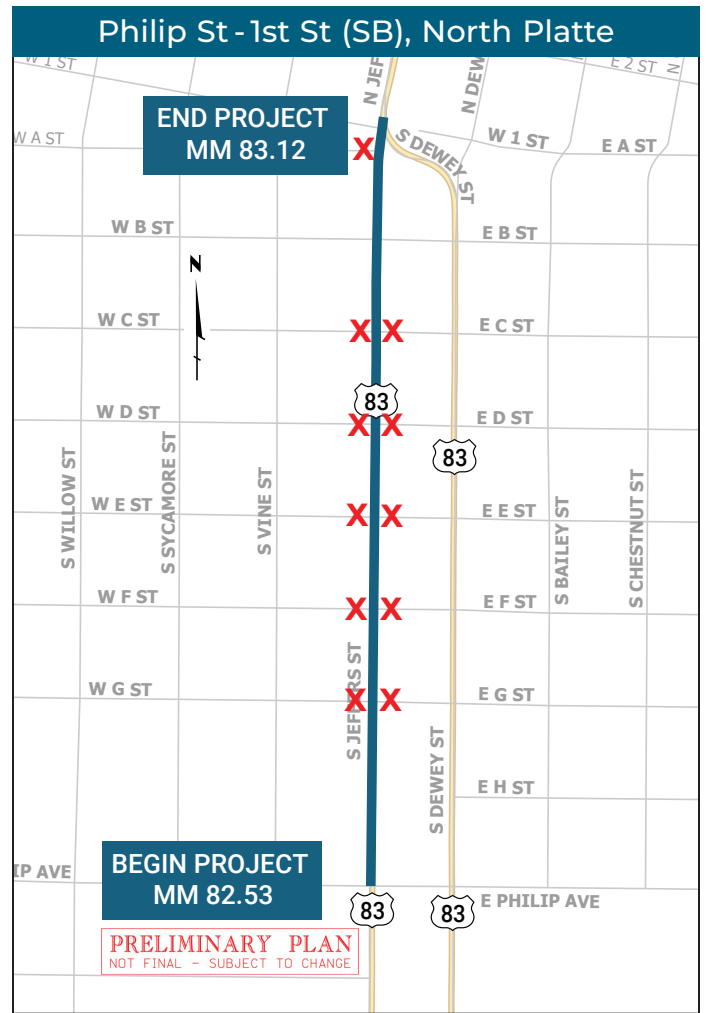

X Temporary side street closure*

*Temporary side street closures would occur at different times during construction, not all at once.