

NEBRASKA DEPARTMENT OF TRANSPORTATION  
NOTICE OF HIGHWAY IMPROVEMENT PROJECT

# Kearney East Bridges

## STP-NH-10-2(125); C.N. 42890

Identified as **Kearney East Bridges**, the proposed project would improve several bridges on Nebraska Highway 10 (N-10) located in Buffalo County.

The proposed project includes the bridge over a bike path and the Platte River, located approximately 0.05 miles north of the junction of East 1st Street and N-10 (Structure Number S010 05229), the bridges over U.S. Highway 30 (US-30) and the Union Pacific Railroad, located approximately 2.39 miles north of the junction of East 1st Street and N-10 (Structure Numbers S010 05463L and S010 05463R), as well as the bridge over Interstate 80 (I-80) located approximately 0.16 miles south of the junction of East 1st Street and N-10 (Structure Number S080 27562). The project includes the lengths of the bridges and 500 feet beyond both ends of the bridge(s) to accommodate maintenance of traffic, transitioning the pavement, bridge work, flume construction, inertial barrier system replacement, and resetting guardrail.

The purpose of the proposed project is to preserve the transportation asset, improve the reliability of the transportation system and perpetuate the mobility of the traveling public. The need for the proposed project is based on the current condition of the bridges.

Proposed improvements on structures S010 05229, S010 05463L, and S080 27562 would consist of a concrete overlay and joint work. New flumes would be constructed at the northwest approach of structure S010 05463L and the northeast and southeast approaches of structure S010 05463R. Guardrail at flume construction locations would be removed and reset. Guardrail surfacing at flume construction locations would be replaced. The inertial barrier array immediately south of S080 27562 would be removed and replaced.

The proposed project would not require the acquisition of additional property rights. Access to adjacent

properties would be maintained during construction but may be limited at times due to phasing requirements. No wetland and/or other water resource impacts are anticipated.

Construction is tentatively scheduled to begin in late spring 2025, with anticipated completion in fall 2025.

The proposed project would be constructed primarily under traffic with lane closures controlled by appropriate traffic control devices and practices; however, the eastbound I-80 off-ramp and on-ramp would be closed for the duration of the bridge work on S080 27562. Eastbound I-80 to northbound N-10 traffic would be detoured eastward on I-80 to Exit 279 (Minden). Traffic would exit and return westbound on I-80 back to Exit 275. Southbound N-10 to eastbound I-80 traffic would be detoured westward on I-80 to Exit 272 (Kearney main interchange). Traffic would exit and return eastbound on I-80.

NDOT has worked to develop this project to minimize inconvenience and hardships. We are dedicated to improving Nebraska's highway system, and with your help, we can achieve this goal.

---

Any questions or comments regarding this project should be submitted to: Sarah Fisher, Public Involvement Specialist, Nebraska Department of Transportation, P.O. Box 94759, Lincoln, NE 68509-4759; [sarah.fisher@nebraska.gov](mailto:sarah.fisher@nebraska.gov); voice telephone 402-479-3832, fax 402-479-3989.

Information regarding the proposed project will be made available on the NDOT website at [ndot.info/42890](https://ndot.info/42890). For those without internet access, information may be obtained through the contact above or at NDOT Headquarters, 1500 Nebraska Parkway, Lincoln, NE. For further information, contact Wes Wahlgren, NDOT District 4 Engineer, 308-385-6265, [wes.wahlgren@nebraska.gov](mailto:wes.wahlgren@nebraska.gov).

# Kearney East Bridges | STP-NH-10-2(125); C.N. 42890

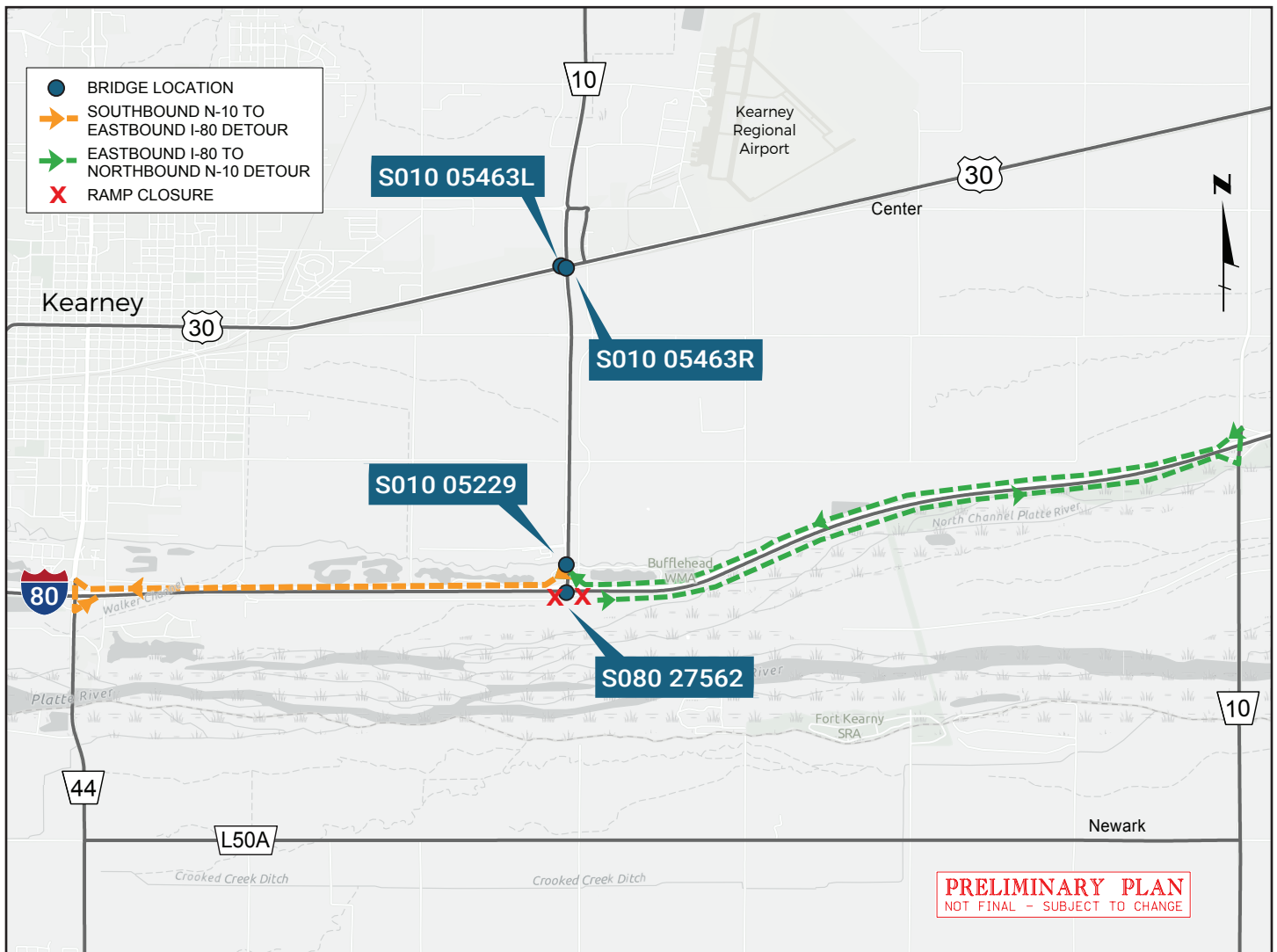

Send comments/questions to:  
 Sarah Fisher  
 NDOT Public Involvement  
[sarah.fisher@nebraska.gov](mailto:sarah.fisher@nebraska.gov)  
 402-479-3832  
 1500 Nebraska Parkway  
 PO Box 94759  
 Lincoln, NE 68509-4759

For more information:  
 Wes Wahlgren  
 NDOT District 4 Engineer  
[wes.wahlgren@nebraska.gov](mailto:wes.wahlgren@nebraska.gov)  
 308-385-6265  
 211 N Tilden St.  
 Grand Island, NE 68802

Information regarding the proposed project will be made available on the NDOT website at [ndot.info/42890](http://ndot.info/42890)