

WELCOME!

Wahoo Intersection

MISC-77-6(1080); CN 13502

Public Information Open House Meeting

Please Sign In

Project Timeline

PRELIMINARY PLAN
NOT FINAL – SUBJECT TO CHANGE

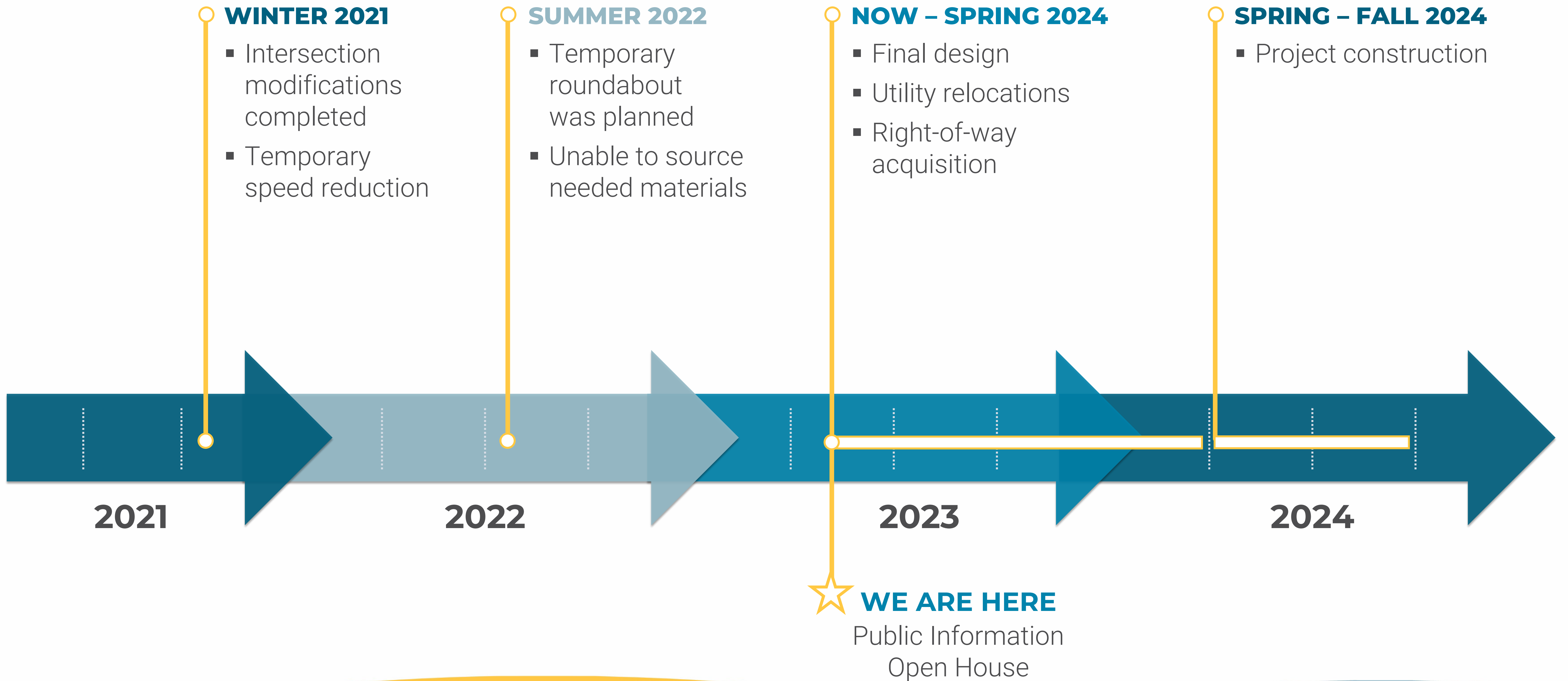

Project Location

Identified as *Wahoo Intersection*, the proposed project would build a roundabout at the intersection of US Highway 77 (US-77) and Nebraska Highway 109 (N-109) in Saunders County.

The planned construction would consist of removing the existing pavement and replacing it with doweled concrete pavement with integral curb. Additional work would include curb inlets, storm sewer and lighting updates. Existing utilities would be reconstructed or relocated as needed.

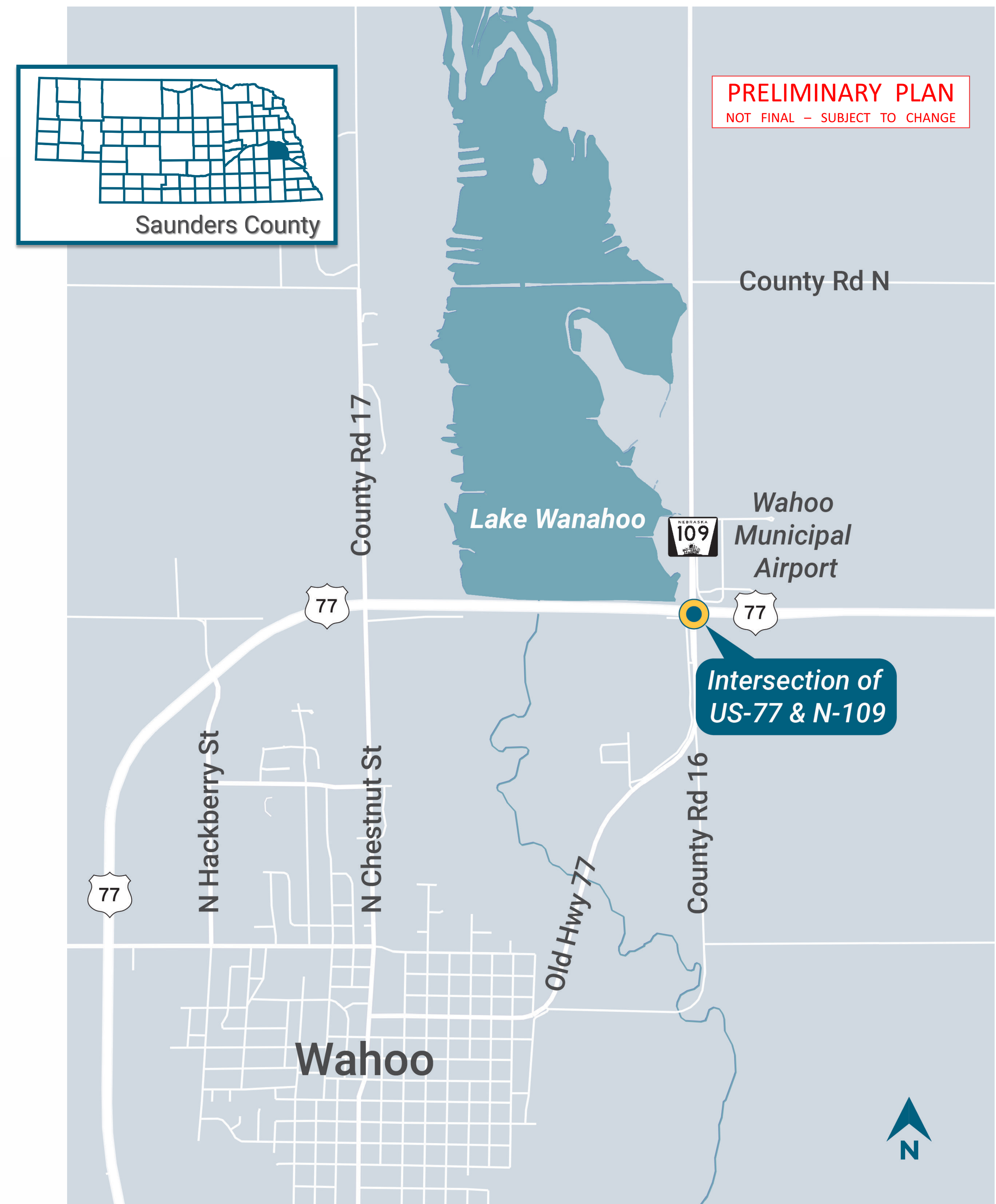

Project Details

Lake Wanahoo

Wahoo
Municipal
Airport

Simodynys Dr

Ponderosa St

Harvest Auto &
Machinery

31st St





Saunders County
Chiropractic &
Acupuncture



PRELIMINARY PLAN
NOT FINAL - SUBJECT TO CHANGE

LEGEND



-  Median Islands
-  Truck Apron
-  Stormwater System
-  New Pavement

GSC Coach-to-Player
Communication
Systems

Commercial Park Rd

Old Hwy 77

Platte Valley
Equipment

Wahoo Intersection
MISC-77-6(1080); CN 13502

NEBRASKA
Good Life. Great Journey.
DEPARTMENT OF TRANSPORTATION

Phase 1 – Proposed Construction

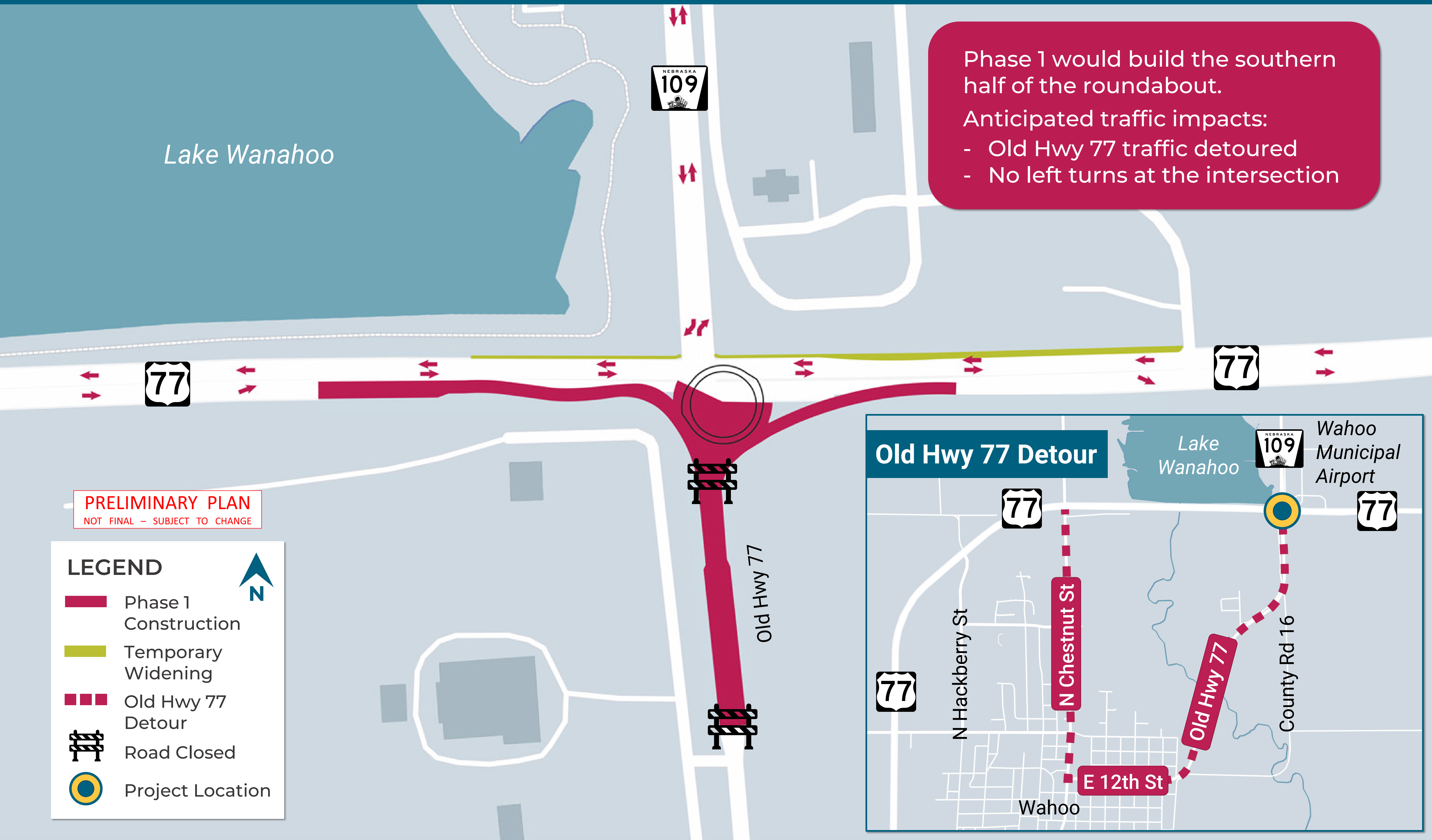

Phase 1 would build the southern half of the roundabout.

Anticipated traffic impacts:

- Old Hwy 77 traffic detoured
- No left turns at the intersection

Phase 2 – Proposed Construction

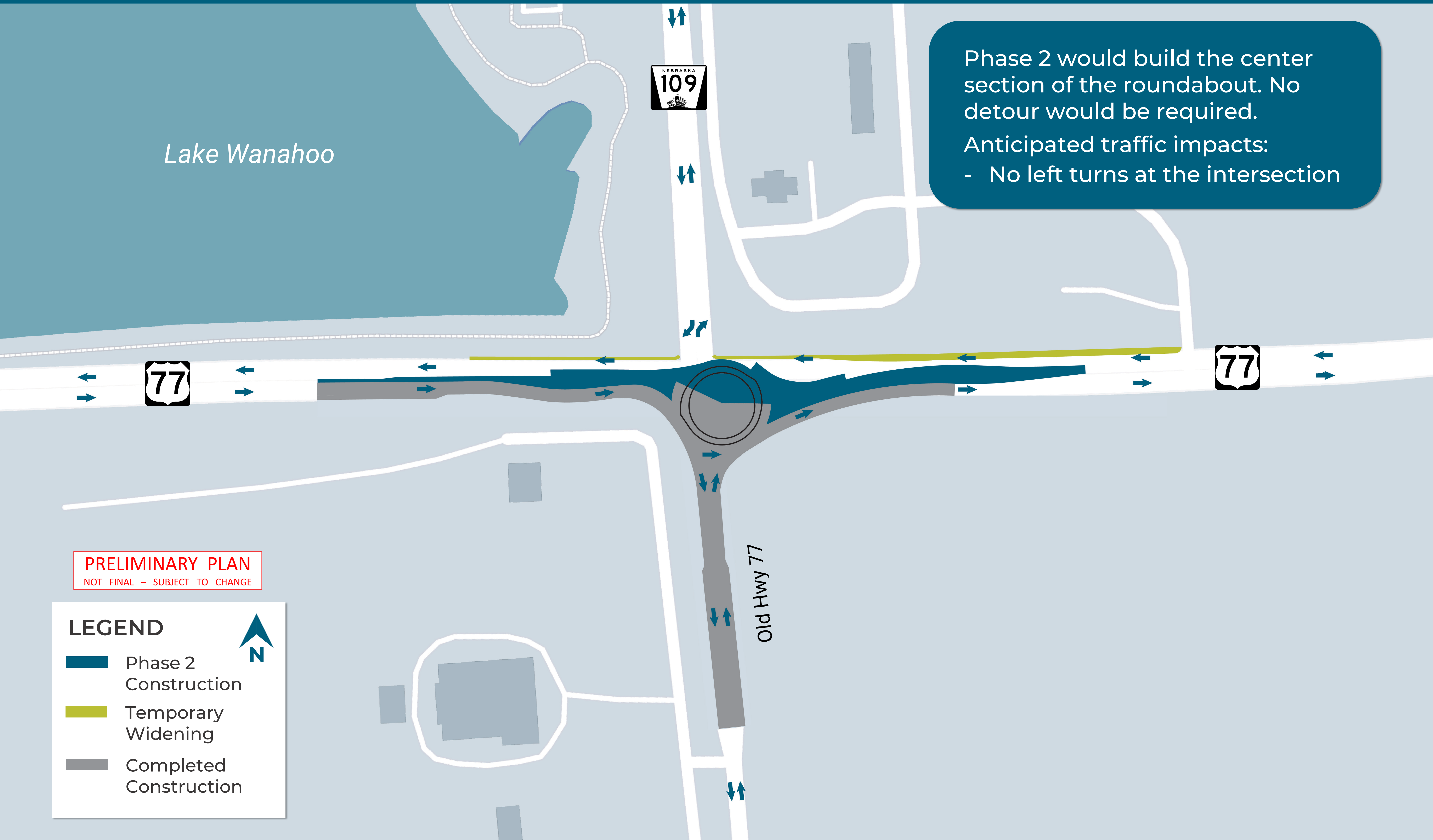

Lake Wanahoo





Old Hwy 77

Phase 2 would build the center section of the roundabout. No detour would be required.
Anticipated traffic impacts:
- No left turns at the intersection

PRELIMINARY PLAN
NOT FINAL – SUBJECT TO CHANGE

LEGEND

-  Phase 2 Construction
-  Temporary Widening
-  Completed Construction



Phase 3 – Proposed Construction

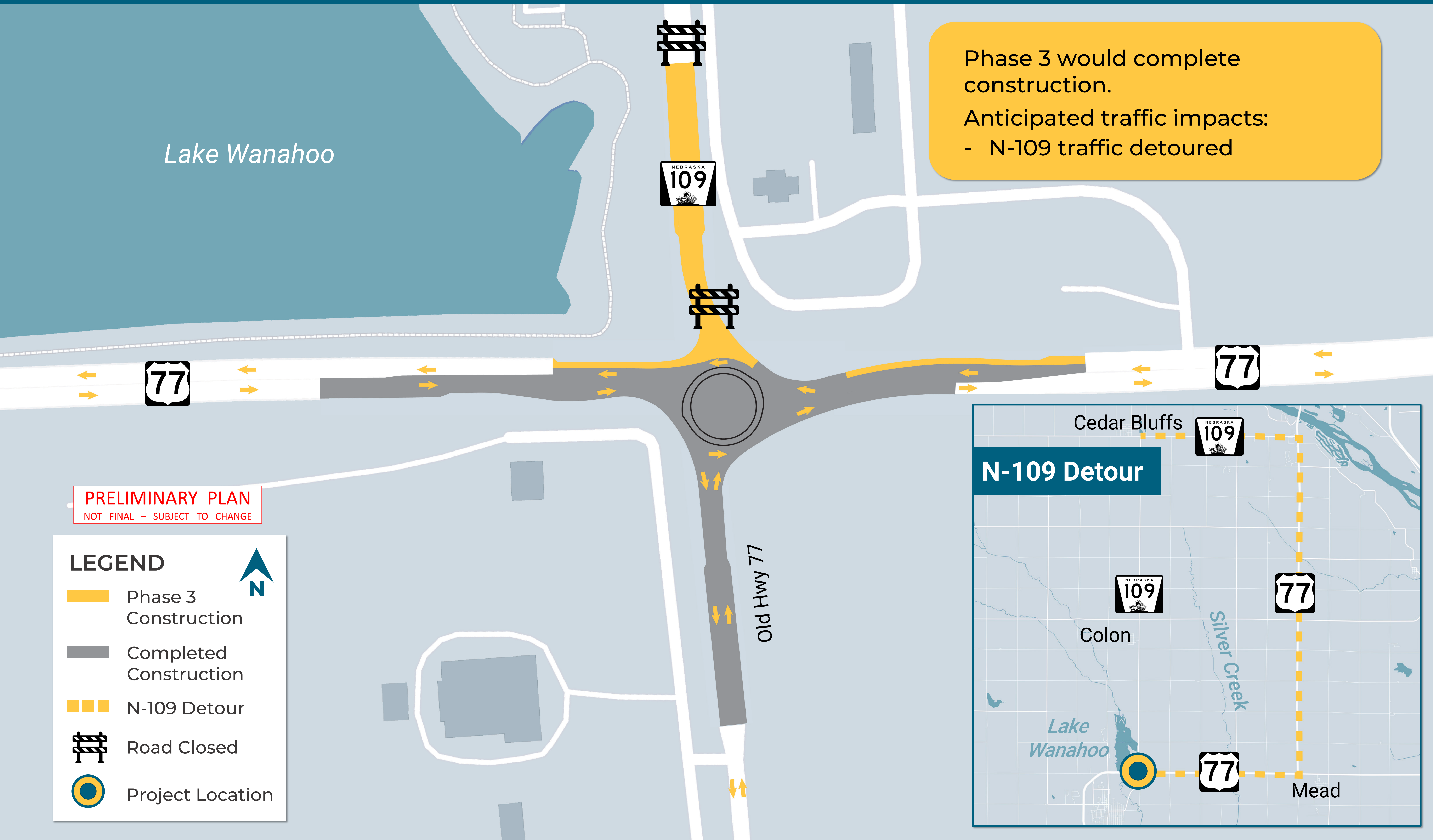

Roundabout Benefits

- Improves safety
- Reduces delays and increases efficiency
- Increases capacity
- Lowers operation and maintenance costs

Conventional intersections have 32 potential conflict points.

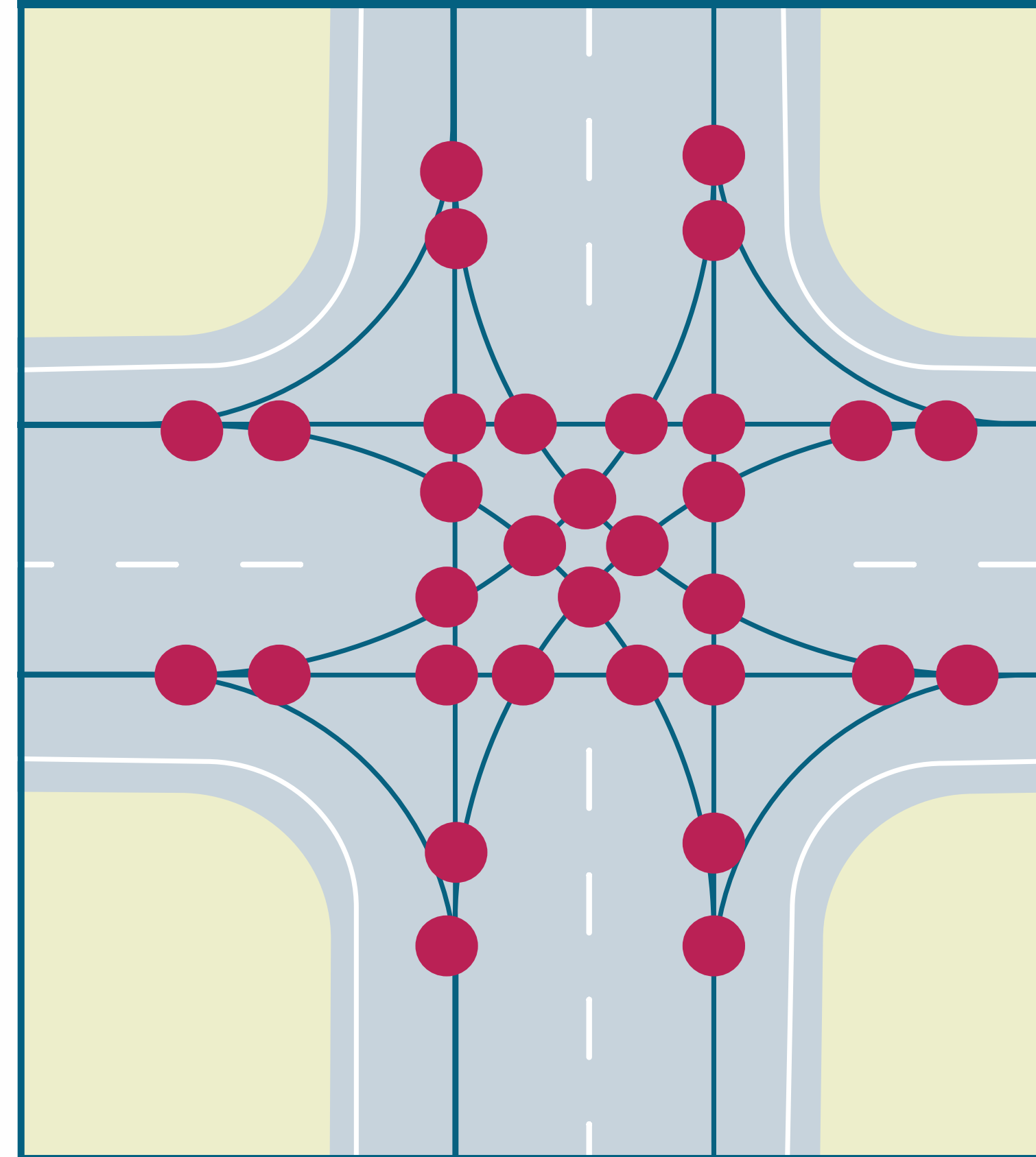

Roundabout intersections have 8 potential conflict points.

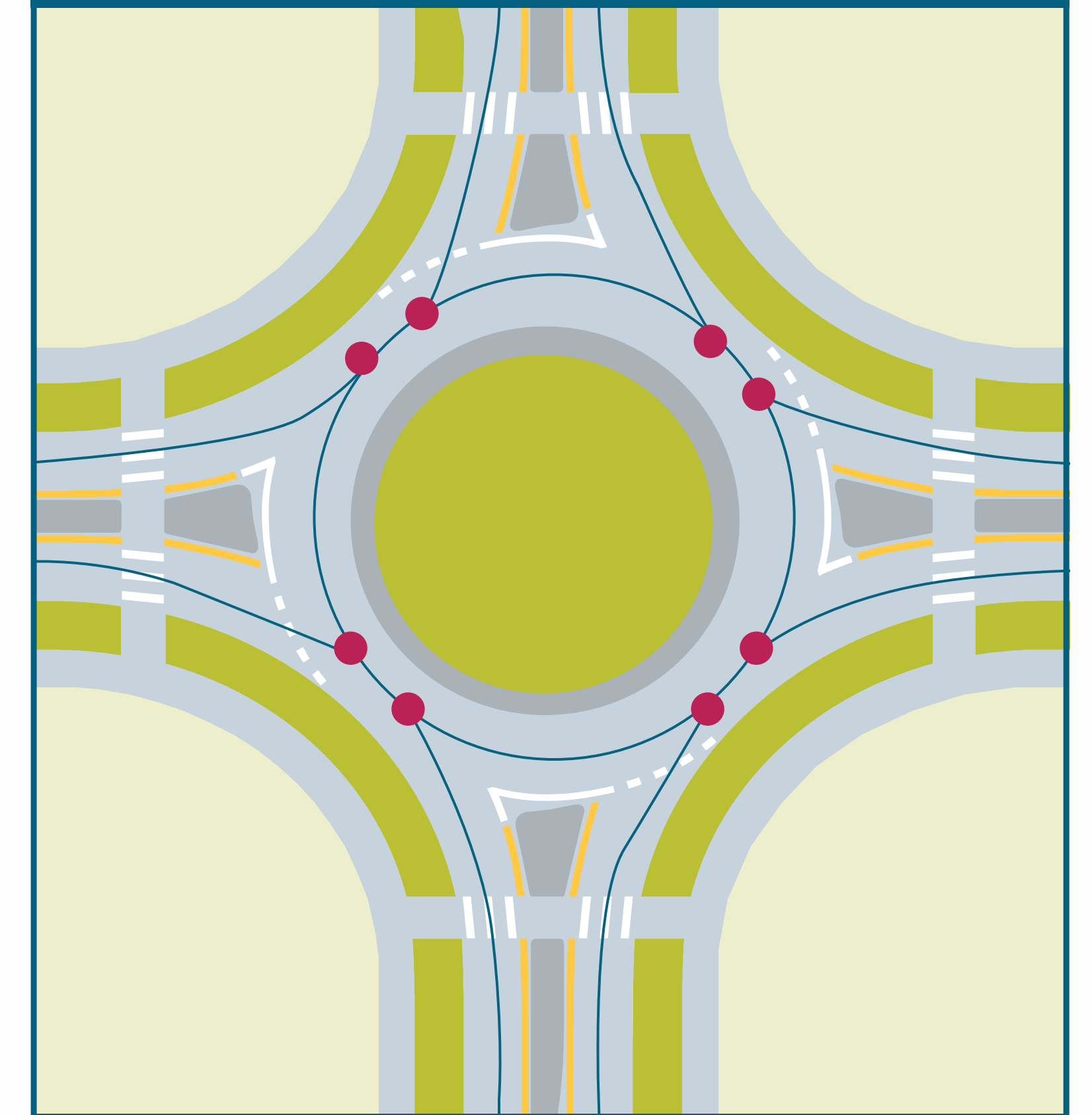

WHAT ABOUT TRUCKS?

Modern roundabouts are designed to accommodate tractor-trailer vehicles through the use of truck aprons. A truck apron is a raised section of pavement around the center island with a mountable curb, which allows for the back wheels of larger vehicles to travel over.

We Want to Hear from you!



Online

NDOT website at
ndot.info/13502

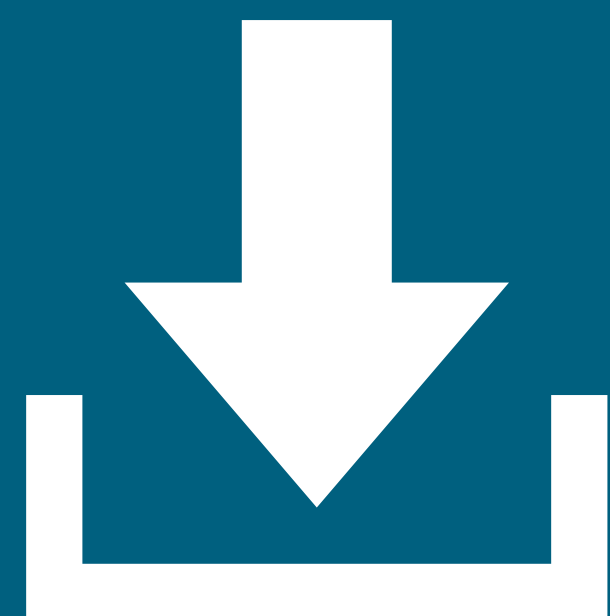

Email

lucas.nelsen@nebraska.gov



Mail

Lucas Nelsen
NDOT Public Involvement
P.O. Box 94759
Lincoln, NE 68509-4759



Comment Box

Leave comment sheet
here with us tonight.

Comments will be collected through May 12, 2023.